

## ASSEMBLY INSTRUCTIONS

## Formosa 17" Flush Mount

Item # KW4904

**NOTICE:**

This light fixture should be installed in accordance with all applicable, local installation codes, and by a person familiar with the construction and operation of it, as well as the hazards involved. Inspect item and contents carefully. If any damage or defect is found, do not install. Retain all packaging material until installation is complete and approved.

**TOOLS REQUIRED (NOT INCLUDED):**

## Phillips Screwdriver

### Slotted Screwdriver

Hammer

Pencil

## Drill

**PERSONS REQUIRED:** Two

1. Carefully remove all parts from the box. Place on a clean, soft surface.
2. Remove mounting plate **(B)** from fixture **(E)** by removing screws **(D)**.
3. Using mounting plate **(B)** as a guide, line up with the junction box and mark anchor positions.
4. Using a drill bit slightly smaller than the anchor, drill holes in the marked positions. Install anchors **(G)** into the holes using a hammer.
5. Install mounting plate **(B)** to the junction box and secure with mounting screws **(C)**, then secure wood screws **(F)** to anchors **(G)**.

**NOTE:** It is recommended to have a helper assist in supporting the fixture for step 6.

6. Hang hooks **(D)** to loops **(H)** on mounting plate **(B)** (see diagram 1).
7. Wrap supply ground wire (usually green or bare copper) around the green grounding screw (see diagram 2). Tighten.

**NOTE:** It is imperative that the fixture is grounded.

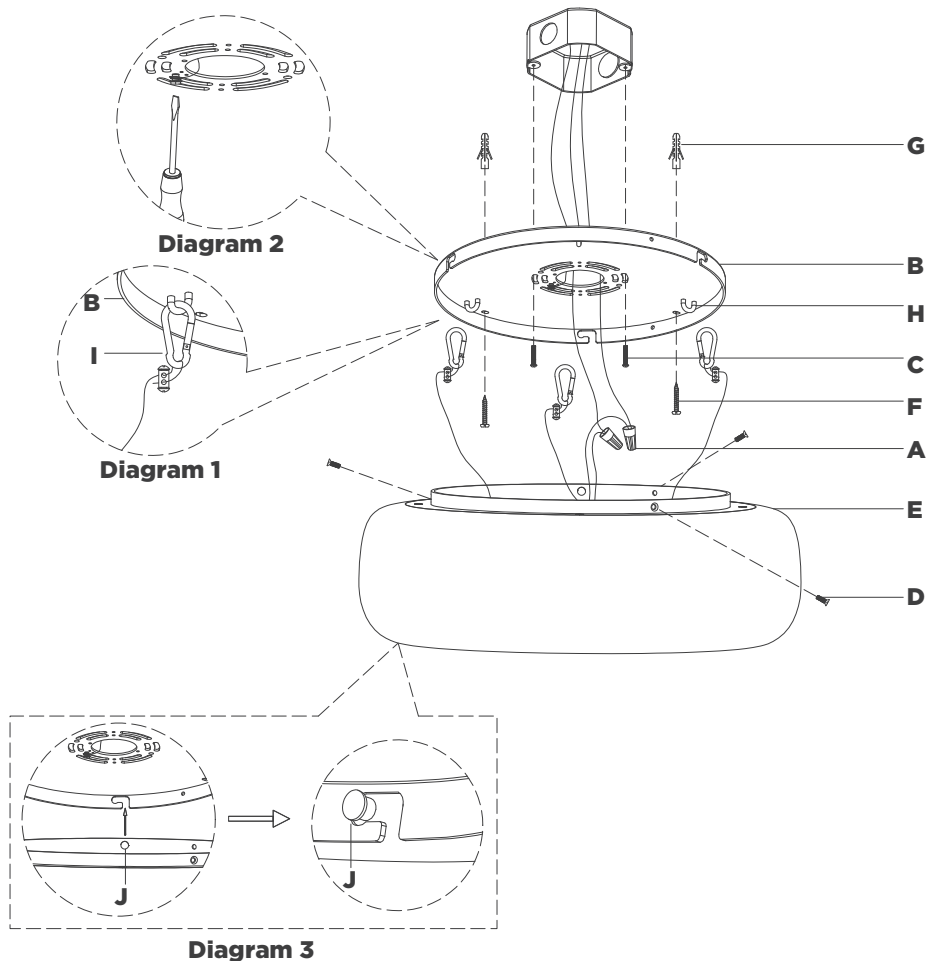

## ASSEMBLY INSTRUCTIONS

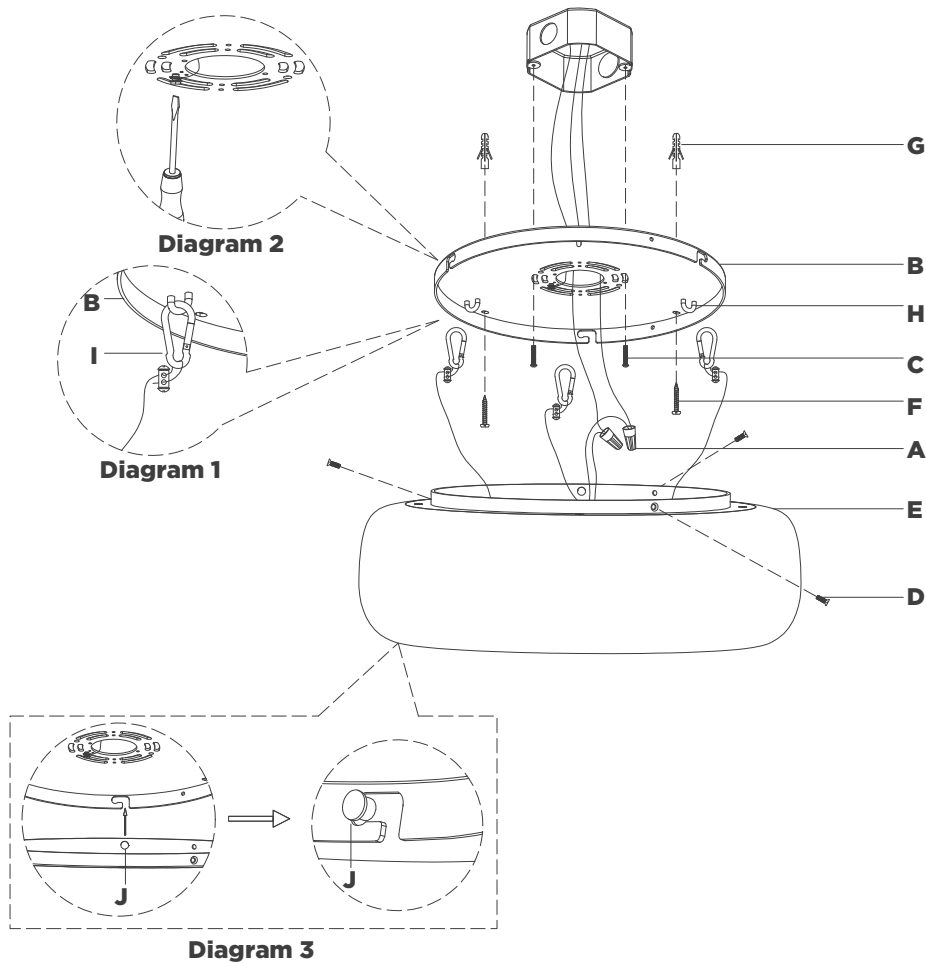

## Formosa 17" Flush Mount

Item # KW4904

### NOTICE:

This light fixture should be installed in accordance with all applicable, local installation codes, and by a person familiar with the construction and operation of it, as well as the hazards involved. Inspect item and contents carefully. If any damage or defect is found, do not install. Retain all packaging material until installation is complete and approved.

8. Connect fixture neutral wire (white) to the supply neutral wire (usually white) using wire nut **(A)**.
9. Connect fixture hot wire (black) to the supply hot wire (usually black) using wire nut **(A)**.  
**CAUTION:** Do not reverse the hot and neutral connections.
10. Make sure all wire connections are tight, then carefully tuck into the junction box.  
**NOTE:** It is recommended to have a helper assist in supporting the fixture for step 11.
11. Align fixture guide pin **(J)** with guide notch on mounting plate **(B)**, then rotate clockwise to hang fixture **(E)** (see diagram 3). Tighten fixture **(E)** by securing screws **(D)**.

**CARE INSTRUCTIONS:** Clean only with a soft dry cloth or feather duster. Do not use abrasive or chemical agents.