

ASSEMBLY INSTRUCTIONS

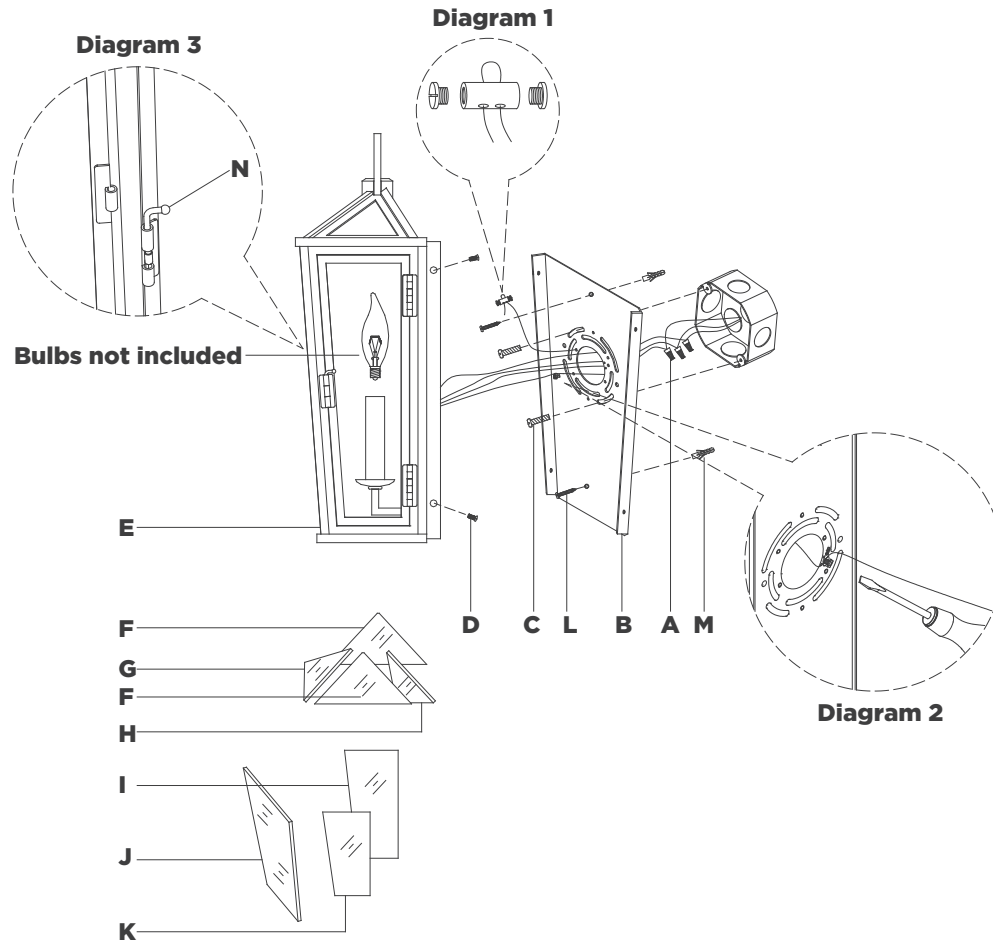

Darlana Small Tall 3/4 Wall Lantern

Item # CHO 2087

NOTICE:

This light fixture should be installed in accordance with all applicable, local installation codes, and by a person familiar with the construction and operation of it, as well as the hazards involved. Inspect item and contents carefully. If any damage or defect is found, do not install. Retain all packaging material until installation is complete and approved.

TOOLS REQUIRED (NOT INCLUDED):

Phillips Screwdriver	Slotted Screwdriver	Hammer
Pencil	Drill	

1. Carefully remove all parts from the box. Place on a clean, soft surface.
2. Remove mounting plate **(B)** from fixture **(E)** by removing screws **(D)**.
3. Using mounting plate **(B)** as a guide, line up with the junction box and mark anchor positions.
4. Using a drill bit slightly smaller than the anchor, drill holes in the marked positions. Install anchors **(M)** into the holes using a hammer.
5. Install mounting plate **(B)** to the junction box and secure with mounting screws **(C)**, then secure wood screws **(L)** to anchors **(M)**.
6. Run safety cable through hole on back of mounting plate **(B)**. Loosen cable lock and install to end of safety cable. Insert other end of cable through the cable lock and tighten ends with a screwdriver to secure (see diagram 1).
7. Wrap fixture ground wire (bare copper) around the green grounding screw (see diagram 2). Tighten. Continue fixture ground wire and connect to supply ground wire (usually green or bare copper) using wire nut **(A)**.

NOTE: It is imperative that the fixture is grounded.

ASSEMBLY INSTRUCTIONS

Darlana Small Tall 3/4 Wall Lantern

Item # CHO 2087

NOTICE:

This light fixture should be installed in accordance with all applicable, local installation codes, and by a person familiar with the construction and operation of it, as well as the hazards involved. Inspect item and contents carefully. If any damage or defect is found, do not install. Retain all packaging material until installation is complete and approved.

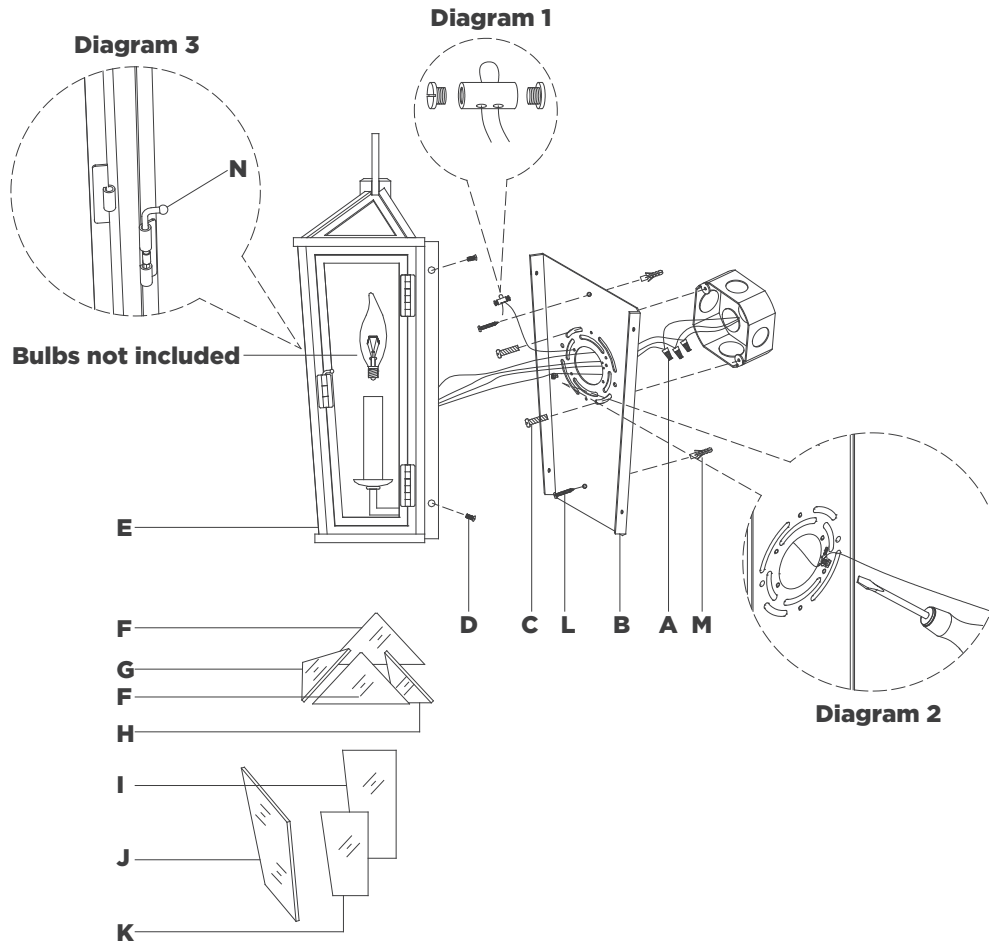

8. Connect fixture neutral wire (white) to the supply neutral wire (usually white) using wire nut **(A)**.
 9. Connect fixture hot wire (black) to the supply hot wire (usually black) using wire nut **(A)**.
- CAUTION:** Do not reverse the hot and neutral connections.
10. Make sure all wire connections are tight, then carefully tuck into the junction box.
 11. Install fixture **(E)** to mounting plate **(B)** and secure with screws **(D)**.
 12. Open door by sliding latch **(N)** (see diagram 3).
 13. Place glass panel **(H)** on the top back of the frame and secure it by bending the metal tabs.
 14. Place glass panels **(F)** on the top both sides of the frame and secure them by bending the metal tabs.
 15. Place glass panel **(G)** on the top front of the frame and secure it by bending the metal tabs.
- NOTE:** Rubber gasket on top of glass must stay in place between glass and fixture frame in order for item to be properly protected from water. Do not remove.
16. Place glass panel **(I)** on the side of the frame and secure it by bending the metal tabs.
 17. Place glass panel **(J)** on the front of the frame and secure it by bending the metal tabs.
 18. Place glass panel **(K)** on the door of the frame and secure it by bending the metal tabs.

ASSEMBLY INSTRUCTIONS

Darlana Small Tall 3/4 Wall Lantern

Item # CHO 2087

NOTICE:

This light fixture should be installed in accordance with all applicable, local installation codes, and by a person familiar with the construction and operation of it, as well as the hazards involved. Inspect item and contents carefully. If any damage or defect is found, do not install. Retain all packaging material until installation is complete and approved.

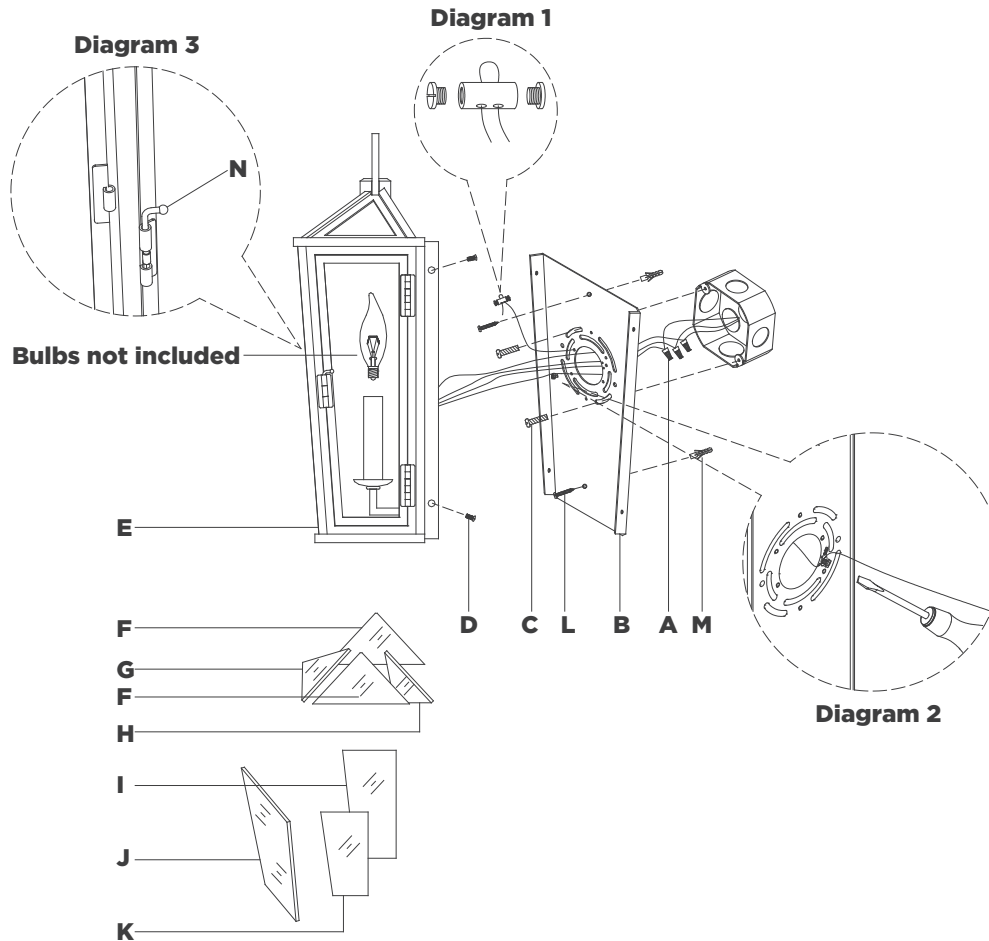

19. Install light bulbs into the sockets, then close door and secure with latch **(N)** (see diagram 3).

FOR OUTDOOR/WET LOCATION INSTALLATION:

20. Using silicone compound, apply a small bead where backplate meets wall to prevent water entering.

NOTE: Large gaps will need to be corrected before applying silicone compound.

CARE INSTRUCTIONS: Clean only with a soft dry cloth or feather duster. Do not use abrasive or chemical agents.